

Camera Setup Guide

Mi Camera 2K (Magnetic Mount)

1. After sign in to *Mi Home App*, tap top right corner “+”, and choose scan
2. Scan the QR code on the bottom of the magnetic base.
3. Reset the device and wait for the voice prompt to say the device is ready.
4. Select *2.4GHz Wi-Fi* and enter password. (During the setup, your phone needs to use the same 2.4GHz Wi Fi,)

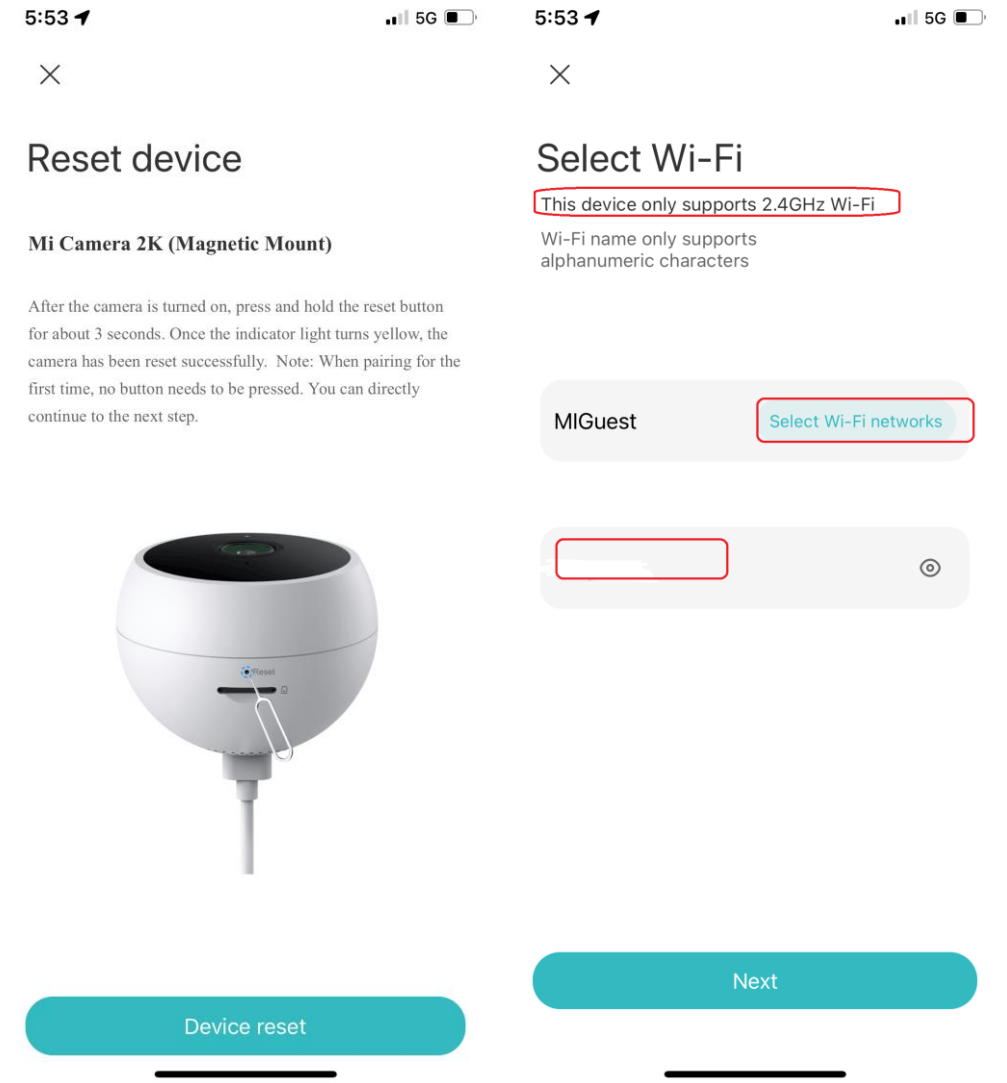
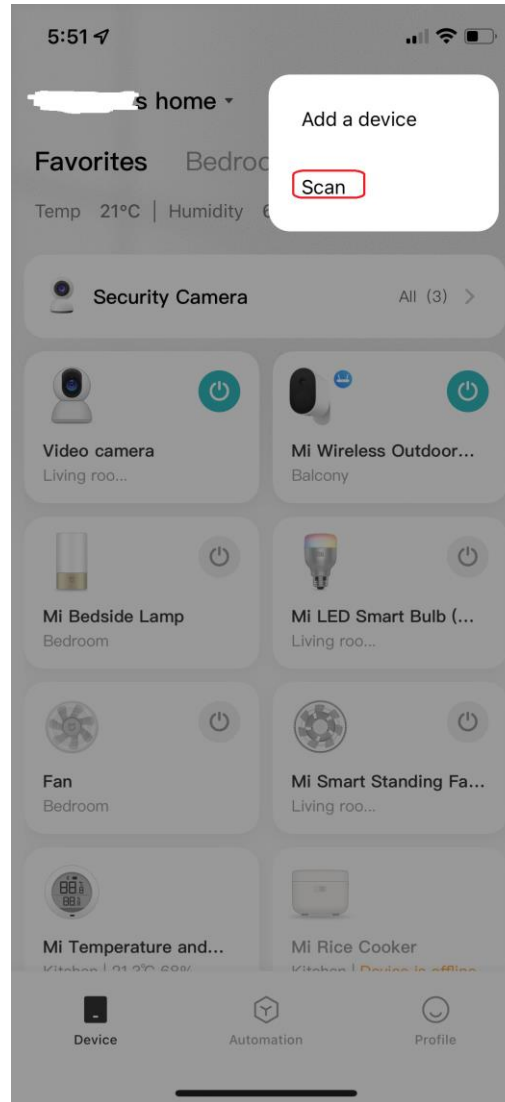

5. The App prompt will ask you to join the camera Wi Fi, choose "Join"

6. If unable to join automatically, click "OK" and then choose "*Manually select*"

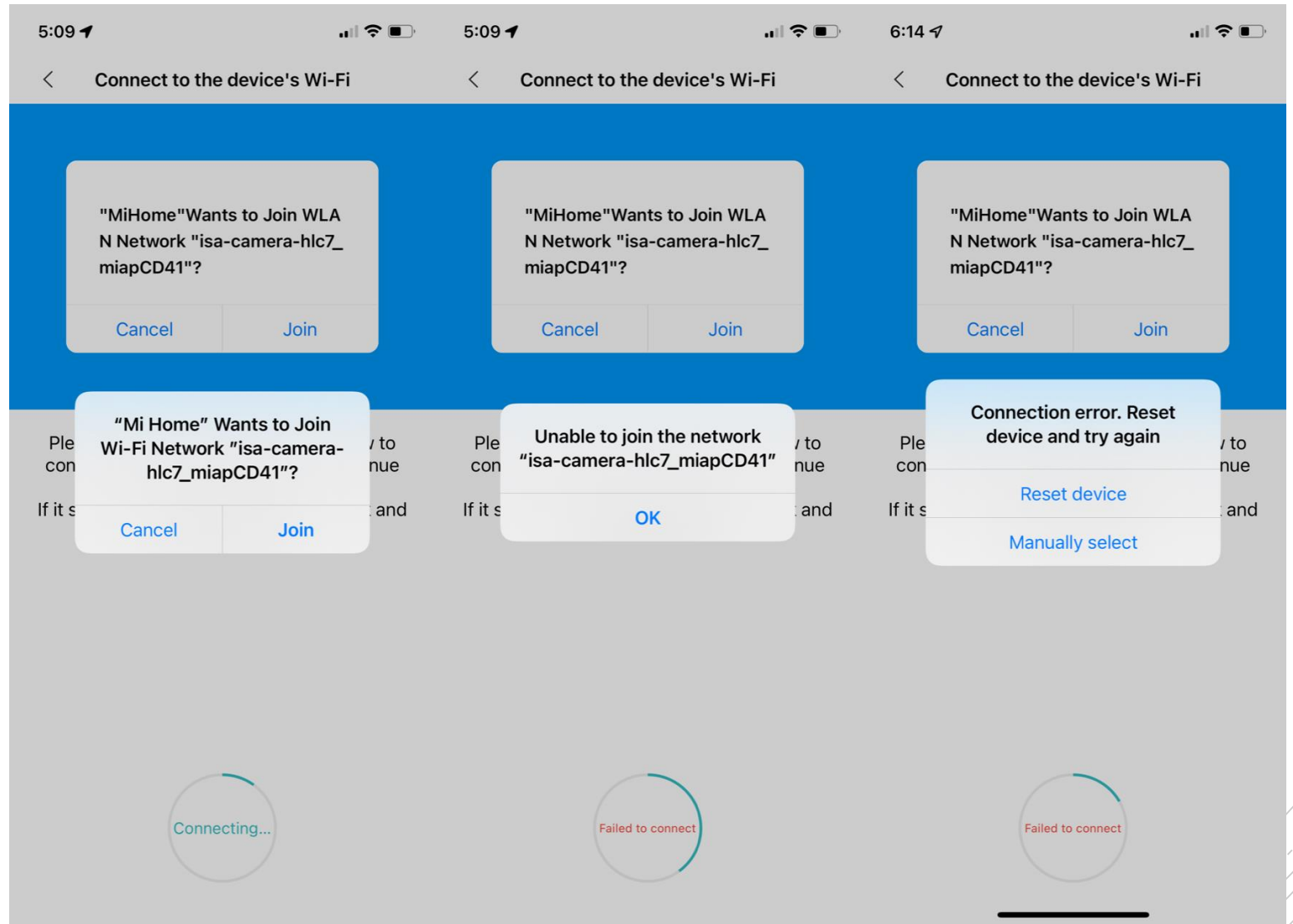

7. Go to the Wi Fi setting, wait for 5 ~10 seconds, then you will see "*isa-camera-hlc7_miap3330*", choose that Wi Fi.

8. Go back to Mi Home App and the camera should connect automatically.

9. In some cases, you might still get a fail message like the picture in the middle. Do not worry, choose "Try again".

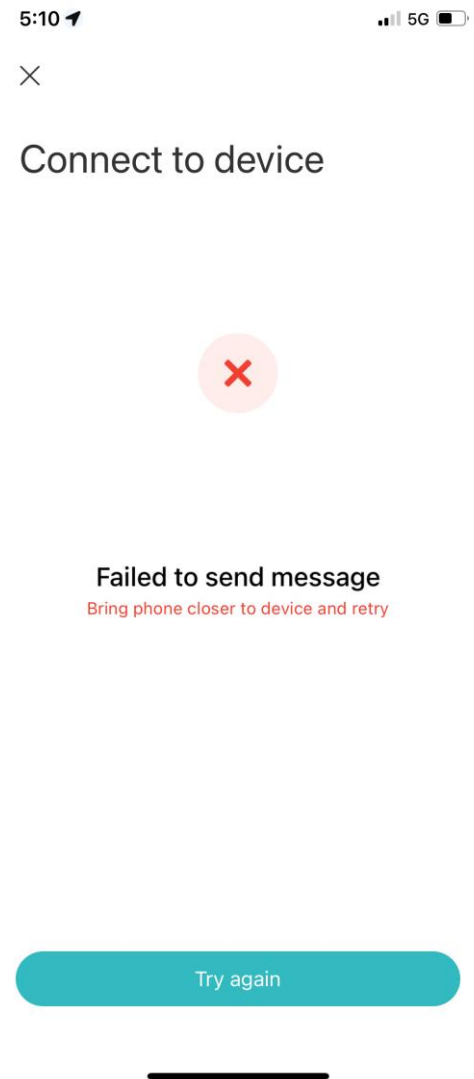
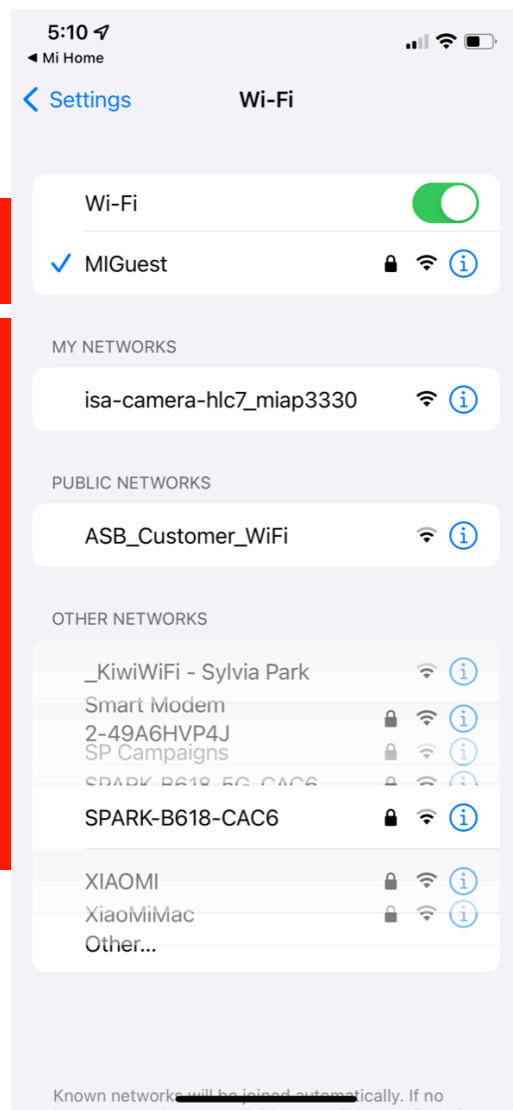

10. It will take you back to the scan QR code page, please select "*Connect manually.*"

11. The camera voice prompt will read out a 4 digit code, enter the pair code to pair.

